

# DUALITE PRE-SPACED IMPRINT APPLICATION INSTRUCTIONS

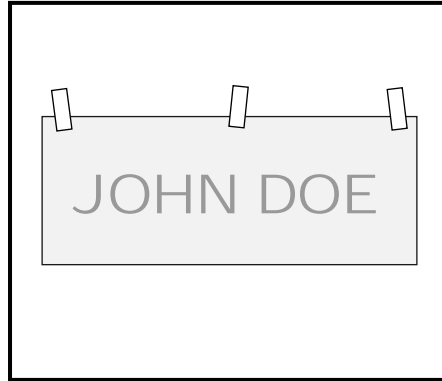

1. Clean application surface regardless of condition. Use a clean cloth with a 2 to 1 mixture of water and isopropyl alcohol. Wipe surface thoroughly clean. Windex or equivalent may be used. Dry surface with clean, lint-free cloth.



2. Position imprint in desired position and secure with tape.

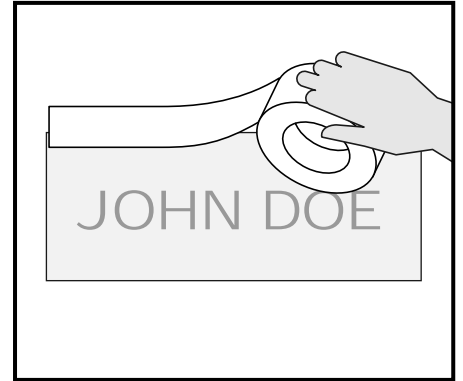

3. Create a Hinge by applying tape along the top of imprint.

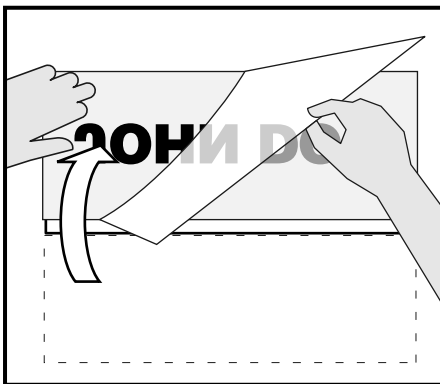

4. Flip imprint over and very carefully remove the liner from the back of the imprint.

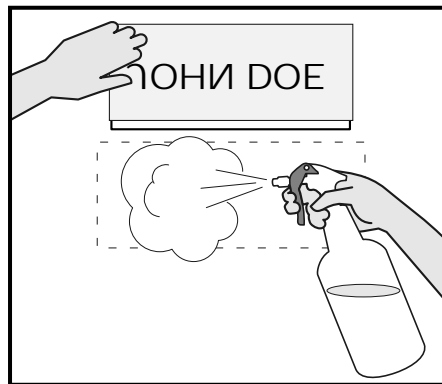

5. At this point you may choose to apply a light spray (1/2 part dishwash detergent to 99 1/2 parts water) to surface. We recommend this step for large applications. The wet surface allows you to make positioning adjustments before imprint permanently adheres to surface.

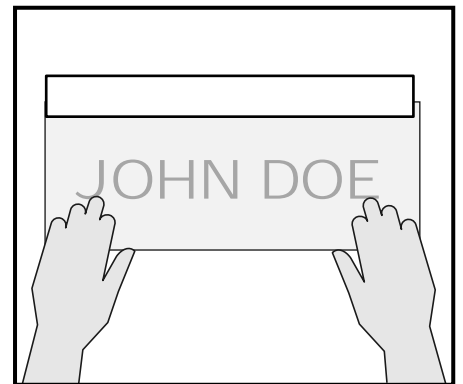

6. Carefully drape imprint back in position.

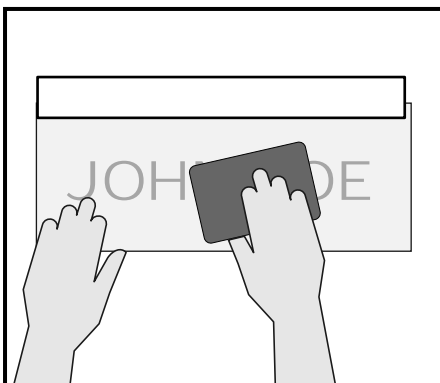

7. Using squeegee with firm pressure, begin at top center and work down and outward to secure imprint to surface. Allow imprint to bond before pulling paper (usually 15 to 30 minutes).

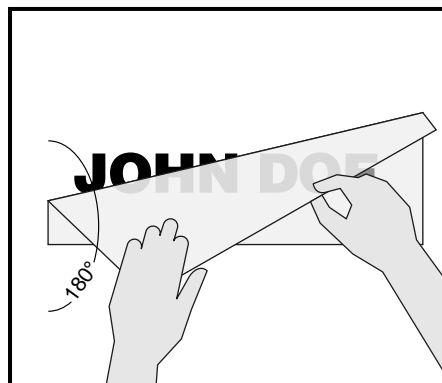

8. Remove the mask covering at a 180° angle, pulling back on itself. Resqueegee entire imprint.

**NOTE:**

This document contains illustrations, concepts and designs, that are exclusive proprietary elements belonging to Dualite Sales & Service, Inc. and may not be copied or reproduced without written consent of Dualite Sales & Service, Inc.

©1999 Dualite Sales & Service, Inc.,  
Williamsburg, OH 45176 - All rights reserved.



Dualite Sales & Service, Inc.

WILLIAMSBURG, OHIO • CEDAR HILL, TEXAS